



KROMSKI & SONS

*Prelude & Interlude*

ASSEMBLY INSTRUCTIONS





# PRELUDE PARTS

\*For the Interlude some parts (e. g. the wheel) are slightly bigger than shown here.

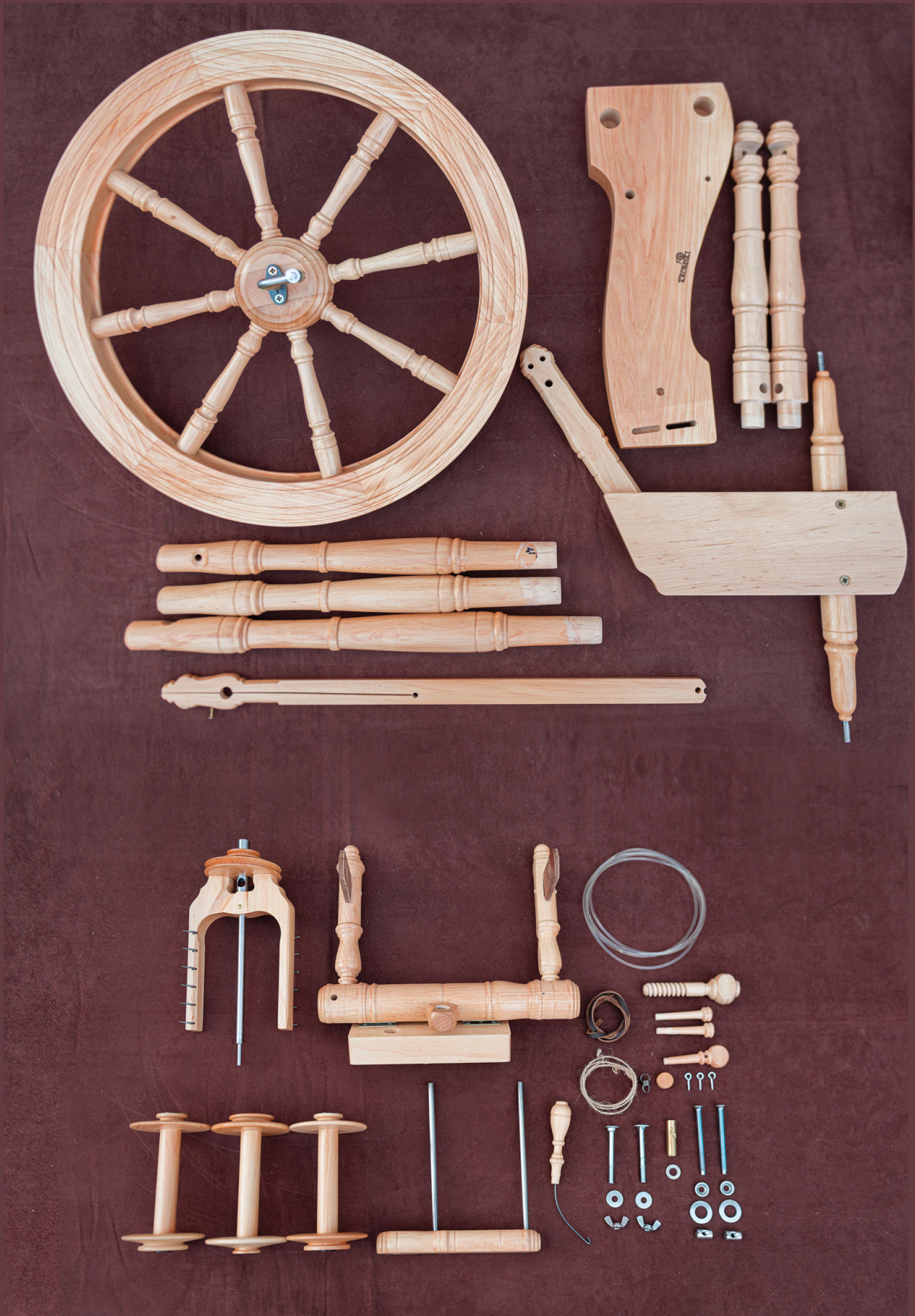



1. Locate the wheel posts and bench.
2. Gather 2 carriage bolts, 2 silver washers, 2 cup washers and 2 barrel nuts. You will also need a flat head screwdriver.
3. Insert the wheel posts into the matching holes on the bench. The holes on the lower part of the post should face the back of the bench.
4. Insert the barrel nut into the holes on the posts.
5. Use the screwdriver to rotate the barrel nut so that the it's hole will align with the bolt from the underside of the bench.



6. Slip the cup washer, followed by the silver washer onto the carriage bolt.
7. With the registration marks aligned, use the hex key to tighten the carriage bolt until it is snug but not tight.

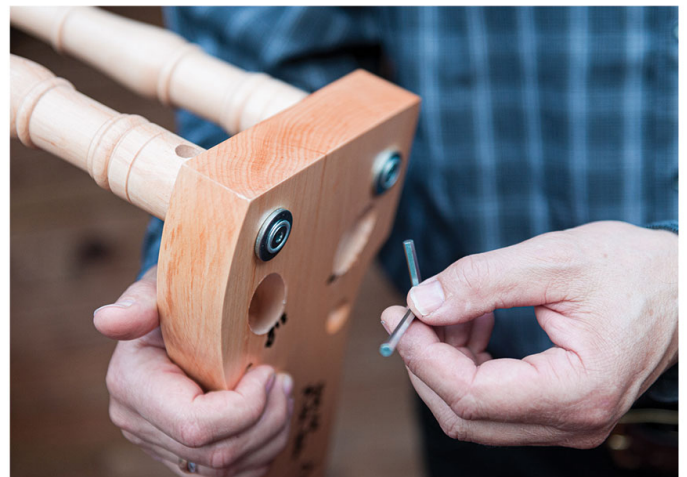



8. Test to see that the posts are correct by holding a flat edge or ruler across the notches at the top. The flat surface on the back of the notch must be flat against the edge of the ruler.
9. Adjust the post as necessary to ensure a proper alignment.
10. Once they are correct, tighten the bolt under the bench completely.

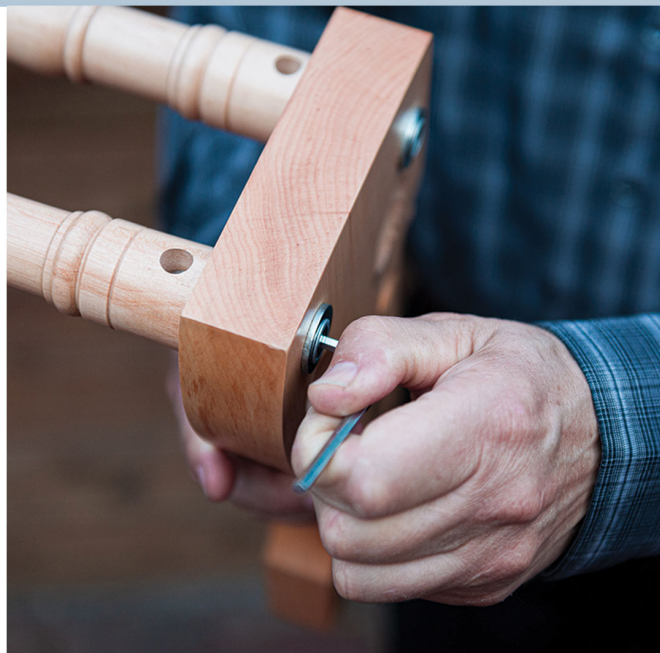

11. Now locate the 3 legs. There are 2 shorter and one longer legs. The chips at the top of the leg is normal. It will not show once assembled. You will also need a light hammer or rubber mallet.
12. Insert the legs into the holes on the underside of the bench. Line up the marks carefully with each leg.
13. Gently tap the legs into place. We do not recommend glueing the legs.

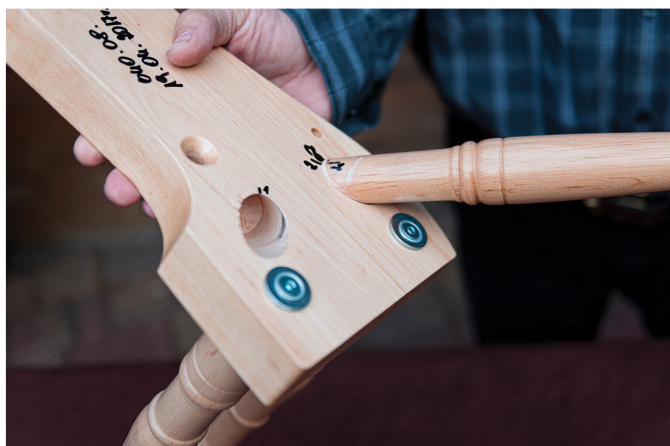



14. Insert the tension adjusting screw into the hole on the Mother-of-all.
15. Rotate the maiden leathers to face the same direction as the tension adjusting screw.
16. Attach the eye screws into the tiny pre-drilled holes on the Mother-of all.
17. Rotate the eye screws so that the outside 2 are vertical and the inside screw is horizontal.
18. Locate the bolt, washer, wing nut and wooden plug.



19. Locate the small peg on the base of the Mother-of All. It will slide into the long slot on the bench. It should go into the one that does not go all the way through the bench.
20. Insert the bolt through the Mother-of all base and down through the slot on the bench. At the same time align the small peg as mentioned in the previous step.
21. Secure the base with the washer and wing nut on the underside of the bench.
22. Cover the top of the screw with the wooden plug. You may glue this in place once you have finished assembling the wheel.





23. Place the drive band between each of the wheel posts and the maiden posts. Let it hang loosely.  
24. Locate the drive wheel, brass bushing, small washer and 2 wheel locking pegs.  
25. Slide the brass bushing onto the wheel axel. The small hole (later used for oiling) should be next to the hub.  
26. Set the wheel onto the wheel posts.

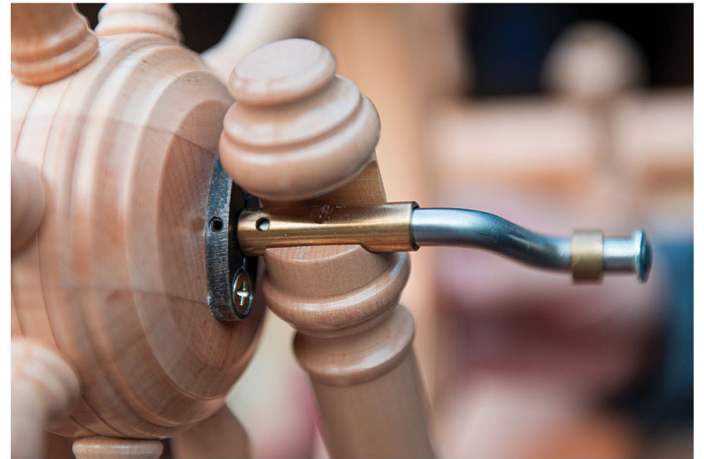

27. Insert the wheel locking peg so that it rests in the groove on the brass bushing.  
28. Push it in until it is snug.  
29. Insert the other wheel locking peg in the same way.





30. Locate the treadle assembly and rail pin.

31. Hold the treadle between the front legs and insert the rail pin through the leg and into the hole on the end of the treadle bar.

32. Tap gently with a small hammer or rubber mallet until the rail pin no longer sticks out from the leg.

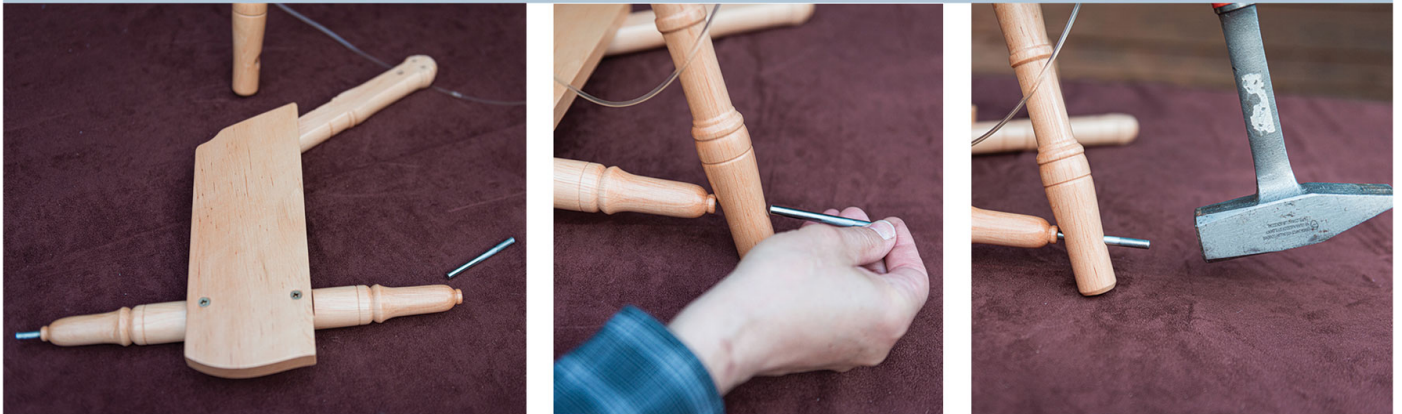

33. Locate the footman and leather tie.

34. Draw the leather through the hole at the bottom of the footman. Tie a knot close to the wood.

35. Gently pry open the top of the footman just enough to slide it over the small bushing on the crank.

36. Use a screw driver to tighten the screw until it is snug. Do not over tighten.

37. The footman should move freely with the help of the bushing.

38. Bring both ends of the leather tie down through the large hole on the treadle. The knot should be tight against the hole in the treadle.

39. Next, bring the ends up through the 2 smaller holes.

40. Tie the leather into a knot. This may need to be redone as the leather stretches with age, so it is best to use a bow knot.





41. Locate the flyer, bobbin, brake band with spring, eye hook and peg.
42. Place a bobbin onto the flyer. Be certain the small pulley on the bobbin is closest to the whorl.
43. Place the drive band over the wheel and the larger whorl. Adjust the tension of the drive band using the tension adjusting screw from step #14.
44. Check that the drive band runs down the center of the drive wheel. If not It will need to be adjusted.

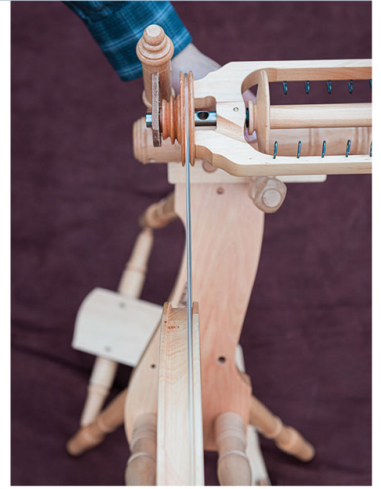
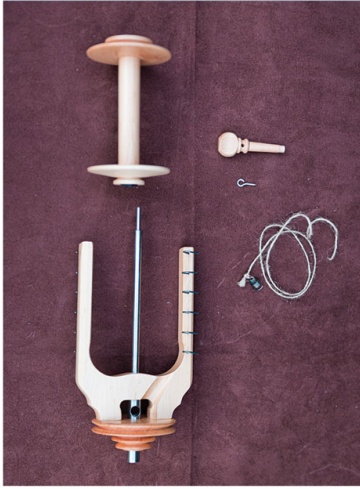

45. Loosen the wing nut under the Mother-of-all and slide the base left or right until the drive band is in the center. Retighten the wing nut when satisfied.
46. Place the spring onto the open eye screw on the far outside of the Mother-of-all base.
47. Bring the brake band over the bobbin pulley.
48. Run the brake band through the other eye screw.
49. Bring the end through the hole on the peg and secure with a square knot.
50. Insert the peg into the hole on the Mother-of-all base.





51. To adjust the tension, rotate the peg. Do not tighten so much that the spring is all the way open. Just a small amount is all you need.

52. Insert an eye screw into the pre-drilled hole on the front of the base. Use this to store the threading hook.

53. If you prefer, skip the above step and store the threading hook in the hole on the bench.



59. Finally locate the lazy kate, carriage bolt, washer and wing nut.

60. Insert the bolt through the kate and the hole on the front of the bench.

61. Secure it with the washer and wing nut.

62. Store extra bobbins on the kate or use when plying.

63. For storage or travel, the Mother-of-all can be rotated off to the side.

64. Loosen the wing nut under the base and lift it up. Place the peg on the underside of the base into the hole that normally sits between the wheel and the MOA. Retighten the wing nut.

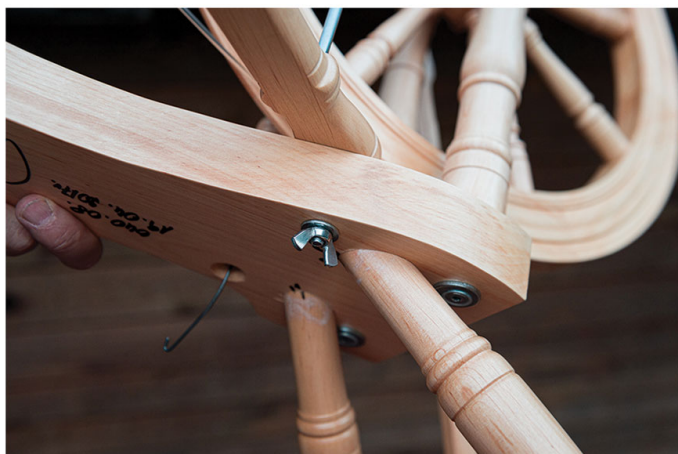
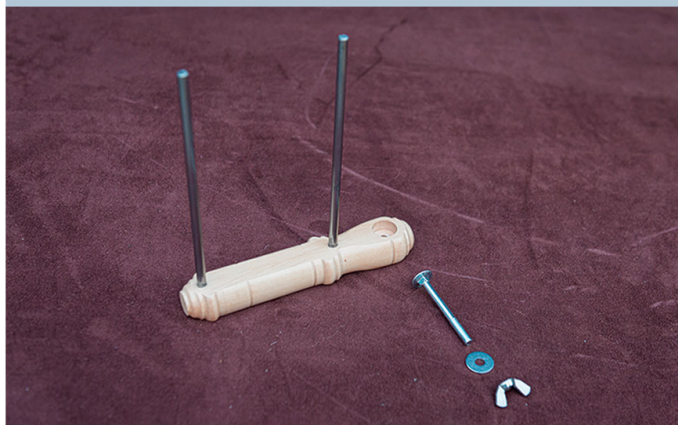



Congratulations! Your Spinning Wheel is ready!



Questions? Comments? Concerns? Contact your dealer or us

**Kromski & Sons**  
**KROMSKI I SYNOWIE s.c.**  
ul. Parkowa 2  
64-200 Wolsztyn  
tel./fax 0048 68 384 28 97  
**tel. 0048 660 799 489**  
[info@kromski.com](mailto:info@kromski.com)

**KROMSKI NORTH AMERICA**  
1103 N. Main St., P.O. Box 247  
Pavo, GA 31778  
**229-859-2001**  
[mail@kromskina.com](mailto:mail@kromskina.com)



# SPINNING ACCESSORIES



TENSIONED LAZY KATES



HAND CARDERS



NIDDY NODDY



NOSTEPINNE



DROP SPINDLE



SPINNING STOOL

# POLISH MERINO WOOL

*see more:*

[www.kromski.com](http://www.kromski.com)  
[www.kromskina.com](http://www.kromskina.com)







KROMSKI FUN  
FACEBOOK GROUP

